

IncuView 3™

All-in-one Incubator



Package Contents

- 1-Base
- 2-Lid
- 3-Turner Motor assembly
- 4-Mesh Floor
- 5-Turner Tray
- 6-Square Reservoir Cap (x3)
- 7-Rectangle Reservoir Cap
- 8-Vent Plug (x2)
- 9-Power Supply

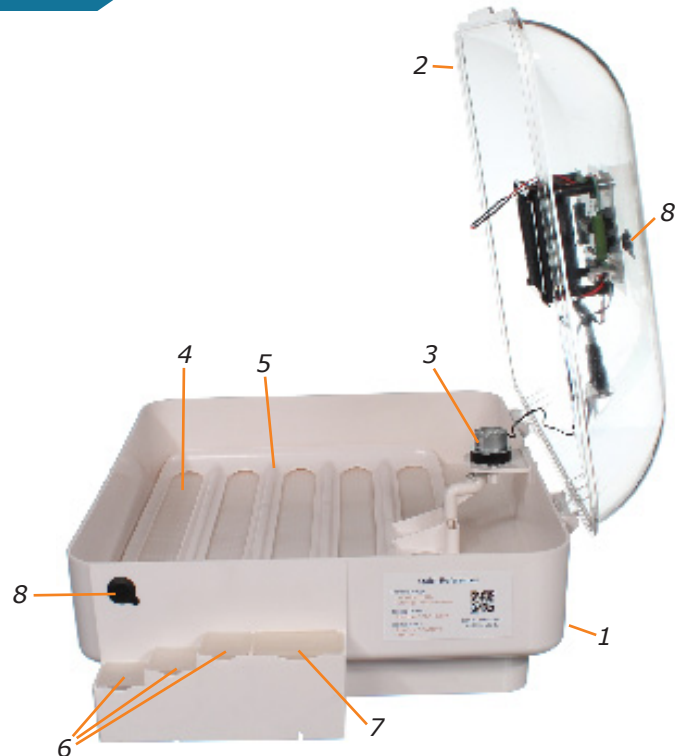

Set-UP

1. Remove all parts from packaging. Leave protective film on lid, for now, to protect from scratches during assembly.
2. Place mesh floor then turner tray in the bottom of the base (they come like this out of the box).
3. Align the hinges on the base and lid and snap them into place. (*image 2*) The lid is designed to lock in an open position, leaving your hands free. Open the lid until you hear a click, this is its locked position.
4. Slide the motor assembly into the slots along the incubator base's back wall, ensuring the turner arm goes into the raised slot in the tray. (*image 3*)
5. Plug the turner motor into power port located on inside of the lid. (*image 4*)
6. Remove protective film from top of incubator and add water to desired level (see Humidity Section for more info) and place reservoir caps on all 4 openings. (*images 5 & 6*)
7. Plug power supply into back of the lid and into power source.

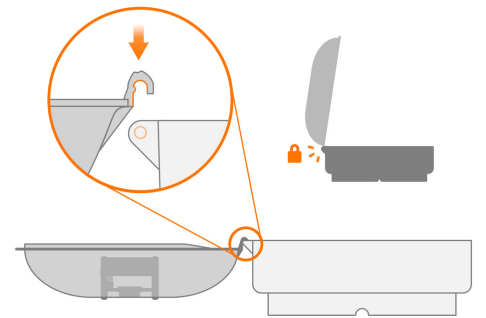

image 2

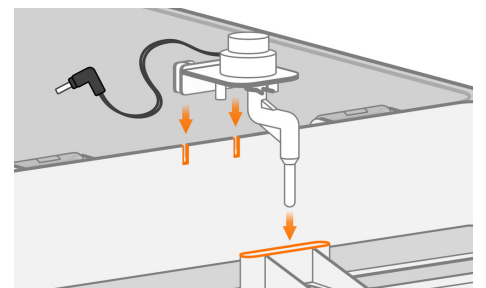

image 3

(image 7) The incubator will automatically power on.

8. Allow your incubator time to get up to temperature and stabilize in humidity, this takes about 1-2 hours.
9. Make sure your hands are clean and set your eggs. Don't crowd them (image 8).
10. Set your hatch timer (image 9), the factory default is 21 days. Time will save when power is lost to the incubator and then continues when power is reconnected.

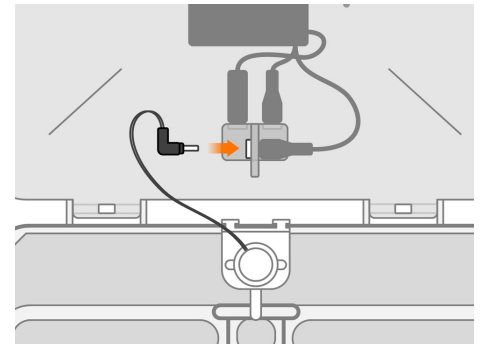

image 4

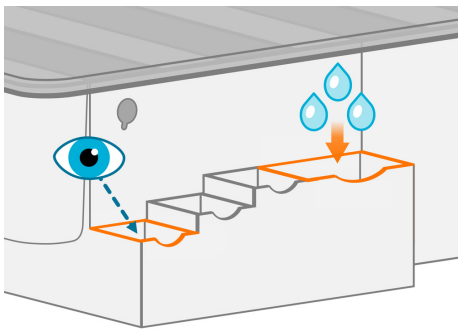

image 5

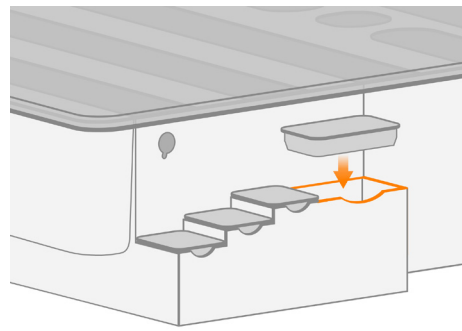

image 6

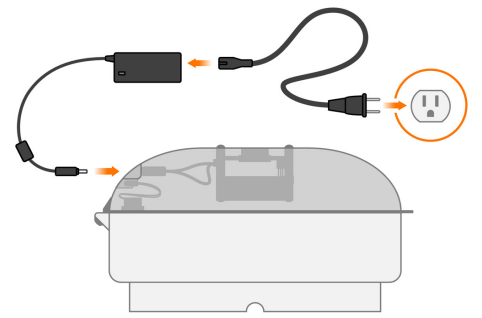

image 7

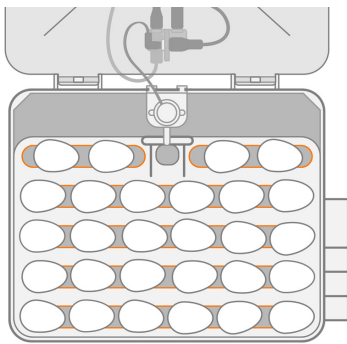

image 8

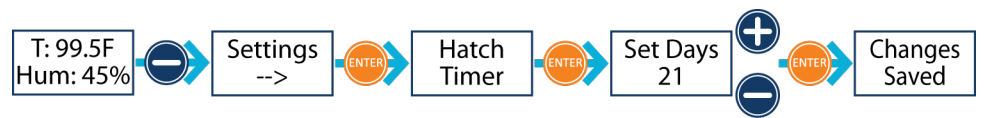

image 9

Humidity

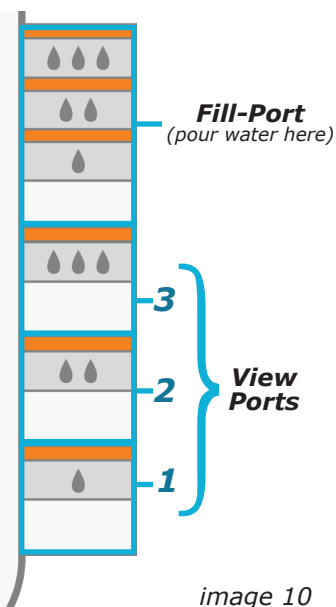

image 10

The IncuView 3 provides easy external fill-ports. You can fill to your desired water level and check the water level inside without opening the lid.

The best way to learn humidity management is to play around with filling the reservoir a bit to get comfortable with how it works before filling your incubator with eggs. It can be helpful to watch how the incubator fills by watching the inside while pouring on the outside. You will notice that Level 3 takes much longer to fill than Levels 1 or 2. This is because it has a lot more surface area and holds much more water.

A Deeper Explanation

The image 10 is of the reservoir fill-ports with their caps removed. There are drops of water shown in each port on the indicator slope that show how much water that reservoir holds. The flat ledge at the top of the indicator slope (colored orange in the image) shows the height of the reservoir inside the incubator. Stop filling just before the water level reaches the flat ledge. If you overflow, the water in the internal reservoir will spill into the next level; which

raises the humidity level until the excess water evaporates. The fill-port (the rectangular port) shows the fill indicators for ports 1, 2, & 3. This is the port that you will pour the water into while you watch the view-port, with the indicator for the water level you want, to see when to stop pouring.

Deciding which water level to use

The humidity level is increased by increasing the surface area of the water. Level 1 (marked with 1 water drop) has the smallest surface area while level 3 (marked with 3 water drops) has the largest surface area for a higher humidity level.

The humidity of the room your incubator is in will affect the humidity percentage. Each reservoir level will generally get you to the levels indicated below. Make adjustments if needed.

Level 1: 35-50%

Level 2: 50-70%

Level 3: 70-80%

During incubation humidity should be between 35-55%, while during lockdown and hatching (the last 3 days) the humidity should be between 60-80%. If you find that your humidity level is too high you can remove one or both of the vent caps to lower it. One vent cap is located on the top of the incubator, the other is on the side above the reservoir view-ports. Removing the reservoir caps will also reduce the humidity level and will cause the incubator to lose water more rapidly, requiring more frequent refills.

Checking the Water Level

Checking the water level is easy with the IncuView 3.

1. Remove the reservoir cap for the level you are using.
2. Look into the port and you will see where the water level is on the indicator slope.
3. Replace reservoir cap when done to prevent evaporation.

Settings & Menu Navigation

When any button is pressed the screen will light up and the light in the incubator will come on. When in the menu, use the PLUS or MINUS buttons to make changes and press ENTER to save. If no button is pushed for 15 seconds the incubator will automatically exit the menu without saving the current change. Make sure to press ENTER after changing any setting to save.

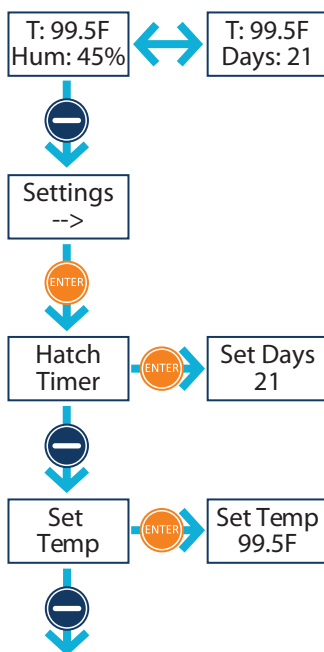

When the unit is running the display will show the current temperature and toggle between showing the humidity and remaining days til hatch.

Press the down button to get to the settings screen and then Enter to enter the settings menu.

Hatch Timer default is 21 days (the time needed for most chicken eggs). It is important to set to the number of days your eggs need because the incubator will automatically turn off the egg turner for the last three days.

Set Temp is the target temperature for the incubator. The default is 99.5 F.

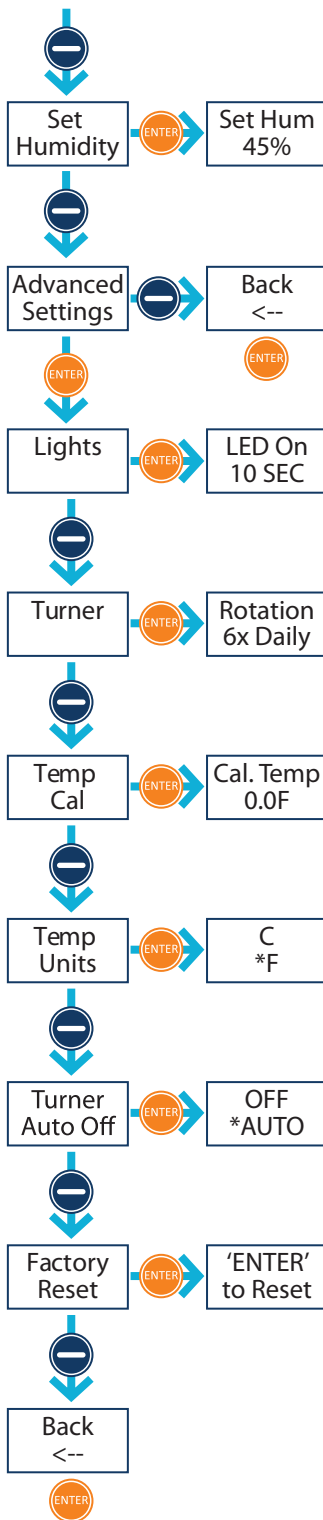

Set Humidity setting works with AccuMist Humidifier (Sold separately). This is the target humidity for the incubator. The incubator will turn on and off the power to the AccuMist in order to maintain the set humidity.

To go into the **Advanced Settings** menu press enter on the 'Advanced Settings' screen. Or you can scroll down to 'Back' screen and hit ENTER to return to main display.

Lights is the amount of time the light in the incubator will stay on after a button has been pushed. The default setting is 10 seconds.

The **Turner** setting will dictate how often your eggs are turned a day. The default is 6x a day. This happens in increments.

Temp Cal allows you to calibrate the built-in thermometer. This usually does not need to be adjusted. See troubleshooting guide for information.

Hum Cal allows you to calibrate the built-in hygrometer. This usually does not need to be adjusted.

The **Turner Auto Off** setting allows control of the auto-off function. When set to OFF the turner will not stop on its own. When set to Auto it will automatically turn off when there are 3 days left on hatch timer. Auto is the default setting.

Factory Reset will return all settings to the factory default